

# electriQ

## **VIRTUAL REALITY GOGGLES**

**Model: VR02**



**Thank you for choosing ElectrIQ**

**Please read this user manual before using these Virtual Reality Goggles and  
keep it safe for future reference.**

**Visit our page [www.electrIQ.co.uk](http://www.electrIQ.co.uk) for our entire range of Intelligent Electricals**

## WARNINGS

- Use only in a safe environment. The headset produces an immersive virtual reality experience that distracts you from and completely blocks your view of your actual surroundings. Always be aware of your surroundings when using the headset. Remain seated whenever possible and take special care to ensure that you are not near other people, objects, stairs, balconies, windows, furniture, or other items that you can trip over, bump into or knock down when using, or immediately after using, the headset. Do not handle sharp or otherwise dangerous objects while using the headset. Never wear the headset in situations that require attention such as walking, cycling or driving.
- Ease into the use of the headset to allow your body to adjust. Use for only a few minutes at first and only increase the amount of time using the headset gradually as you grow accustomed to virtual reality.
- Do not use the headset when you are tired or under the influence of alcohol or drugs as this can increase your susceptibility to adverse symptoms.
- Take a 10 to 15 minute break every hour, even if you don't think you need it. Each person is different so take more frequent and longer breaks if you feel discomfort.
- If you experience discomfort immediately discontinue use.
- Do not use whilst the mobile phone is charging.
- Remove glasses before use.
- Not suitable for children under the age of 3.
- Children should be supervised whilst using the device and use limited to 30 minutes at a time.

# GOGGLES

Inter pupillary distance adjustment wheel



Removable front cover

Object distance adjustment



Ergonomic face pad

Lens

Focus adjustment ring

## COMPATIBLE DEVICES

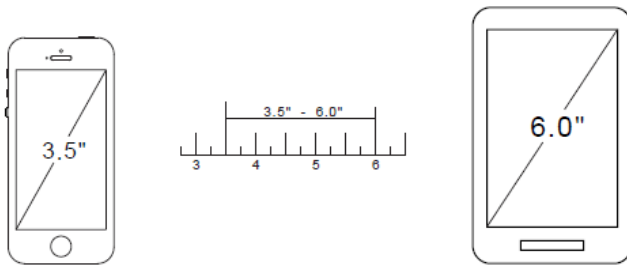

The goggles can accept most devices with screens from 3.5” to 6.0”.

## HOW TO USE

Select a virtual reality app to play or video to watch on your mobile phone. Orientate the phone horizontally.

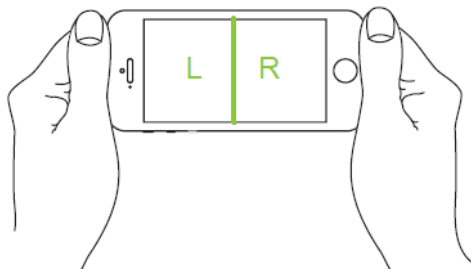

Open the front of the goggles by flipping down the front section.

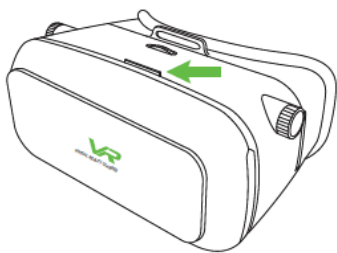

Insert your mobile phone into the holder on the front of the front section. The spring loaded holders will open and close to hold your phone securely.

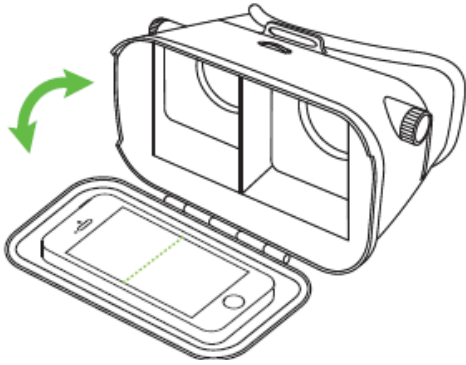

Close the front of the goggles again.

Place the head strap over your head and adjust the straps using the Velcro adjustments.

The goggles can be adjusted for the individual user's vision.

The pupillary distance can be adjusted by rolling the adjuster in the centre of the top either right or left.

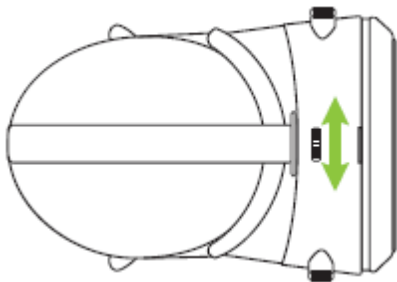

The object distance can be set by rotating the knobs on the left and right side of the goggles clockwise or counter clockwise.

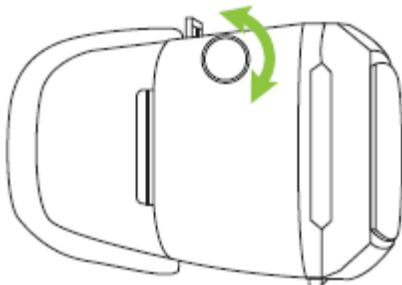

To adjust the focus of the goggles, twist the focus rings on the inside of the goggles, around the lenses. This can be used to correct prescriptions that normally require glasses.

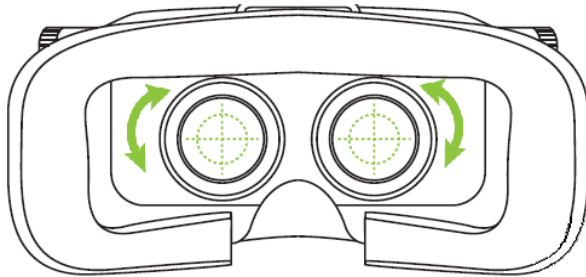

You are now ready to enjoy virtual reality.

## **GETTING STARTED: GOOGLE CARDBOARD AND OTHER VR PLATFORMS**

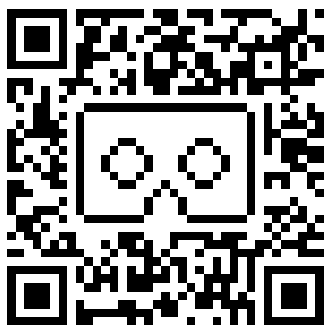

If you are using the VR device with cardboard games you need to download the Cardboard app. Once you have installed the Cardboard app you are walked through a simple set up process. The app will ask you to scan the QR code provided with your headset or VR accessory and doing so will calibrate any apps using the Cardboard SDK to match the lens type and fit in your headset. You

can always use the default Cardboard settings, but the sticker calibration method ensures you are getting the best VR experience.

Outside of the official Cardboard app, there are tons of apps that support this same split-screen visual format and work great within Cardboard.

Many of these experiences are highly visual, or include some simple and addictive gameplay mechanic, but nearly all of them are made better with the addition of a decent set of headphones or earbuds; quality audio completes the VR immersion.

Also search your favourite app market for terms as VR, cardboard, VR Games, VR theatre, VR player or platforms as Nibiru, Fibrum etc.

There is also a 360 degrees youtube channel that will benefit of VR goggles use.

# electriQ UK SUPPORT

[www.electriQ.co.uk/support](http://www.electriQ.co.uk/support)

Complete online support form on: [www.electriQ.co.uk/support](http://www.electriQ.co.uk/support)

Customer Service Line: 0871 620 1057

Office hours: 9AM – 5PM Monday to Friday

[www.electriQ.co.uk](http://www.electriQ.co.uk)

Unit 2, The Nursery

Berristow Lane

South Normanton

Derbyshire

DE55 2FX